



FRONT ELEVATION "A"



FRONT ELEVATION "B"

GRID DESIGN TO BE AT BUILDER'S DISCRETION

CUSTOMER SIGNATURE

DATE

THE "AMELIA 4"

PLAN-1868UR2342

BUILDER RESERVES THE RIGHT TO CHANGE PLANS WITHOUT WRITTEN NOTICE OR PRIOR APPROVAL. FLOOR PLAN AND ELEVATION ARE FOR ILLUSTRATIVE PURPOSES ONLY. ALL LAYOUTS AND DIMENSIONS ARE APPROXIMATE AND ARE SUBJECT TO REASONABLE ENGINEERING AND CONSTRUCTION VARIANCES.

APRIL 18, 2011



FRONT ELEVATION "C"

CUSTOMER SIGNATURE

DATE



THE "AMELIA 4"

PLAN-1868UR2342

BUILDER RESERVES THE RIGHT TO CHANGE PLANS WITHOUT WRITTEN NOTICE OR PRIOR APPROVAL. FLOOR PLAN AND ELEVATION ARE FOR ILLUSTRATIVE PURPOSES ONLY. ALL LAYOUTS AND DIMENSIONS ARE APPROXIMATE AND ARE SUBJECT TO REASONABLE ENGINEERING AND CONSTRUCTION VARIANCES.

APRIL 18, 2011

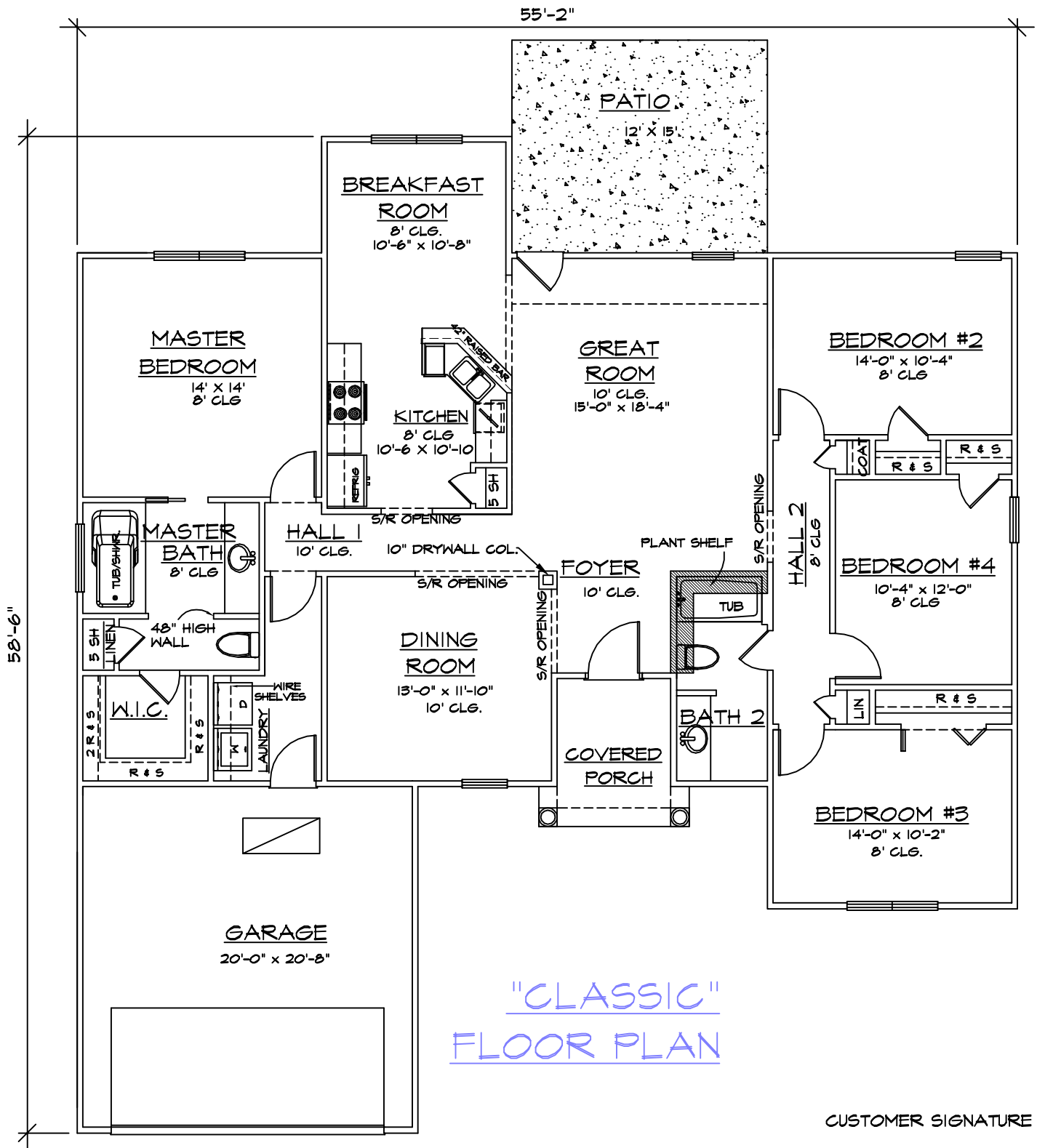

"CLASSIC"
FLOOR PLAN

CUSTOMER SIGNATURE

DATE

THE "AMELIA 4"
PLAN-1868UR2342

NOTE:
GARAGE ORIENTATION DEPENDS
ON COMMUNITY STANDARDS. AN
ADDITIONAL CHARGE WILL APPLY
WITH A SIDE-ENTRY GARAGE THAT
IS NOT NOTED AS AN "56" PLAN.

BUILDER RESERVES THE RIGHT TO CHANGE PLANS WITHOUT WRITTEN NOTICE OR PRIOR APPROVAL. FLOOR PLAN AND ELEVATION ARE FOR ILLUSTRATIVE PURPOSES ONLY. ALL LAYOUTS AND DIMENSIONS ARE APPROXIMATE AND ARE SUBJECT TO REASONABLE ENGINEERING AND CONSTRUCTION VARIANCES.

ADDITIONAL AVAILABLE KITCHEN FEATURES

- * ROPE TRIM IN UPPER CABS
- * 42" UPPER CABS
- * GLASS DOOR IN CABINET
- * PLATE RACK
- * WINE RACK
- * BANK OF DRAWERS
- * SINK TIP-OUT TRAY
- * SPICE INSERT
- * ROLL-OUT TRAYS
- * FREE-STANDING TRASH COMPACTOR

ADDITIONAL AVAILABLE MASTER BATH FEATURES

- * VANITY BOUTIQUE
- * BANK OF DRAWERS

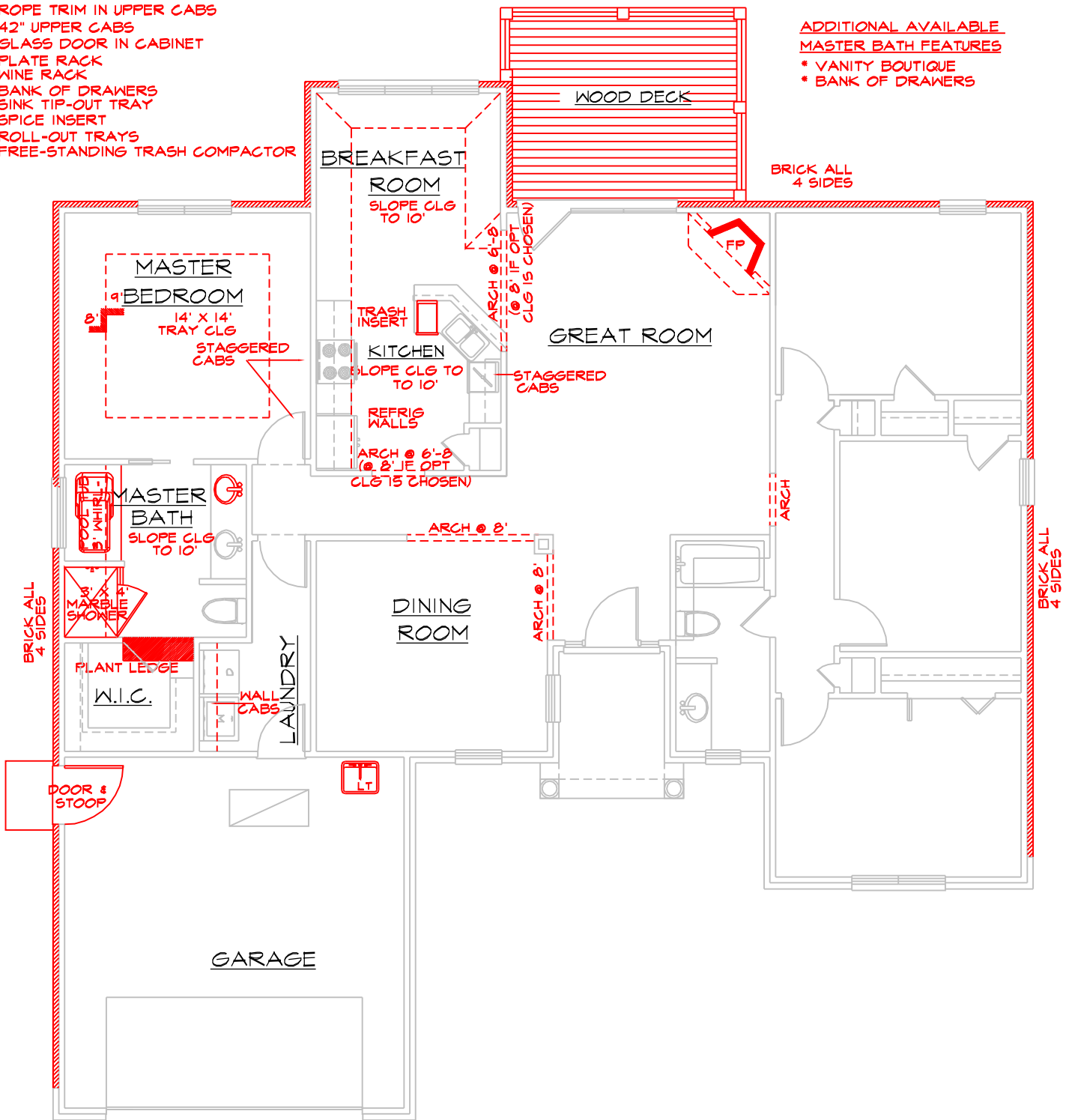

NOTE:
GARAGE ORIENTATION DEPENDS ON COMMUNITY STANDARDS. AN ADDITIONAL CHARGE WILL APPLY WITH A SIDE-ENTRY GARAGE THAT IS NOT NOTED AS AN "SG" PLAN.

AVAILABLE FEATURES

THE "AMELIA 4"

PLAN-1868UR2342-B

CUSTOMER SIGNATURE

DATE

BUILDER RESERVES THE RIGHT TO CHANGE PLANS WITHOUT WRITTEN NOTICE OR PRIOR APPROVAL. FLOOR PLAN AND ELEVATION ARE FOR ILLUSTRATIVE PURPOSES ONLY. ALL LAYOUTS AND DIMENSIONS ARE APPROXIMATE AND ARE SUBJECT TO REASONABLE ENGINEERING AND CONSTRUCTION VARIANCES.